

KORETECK® Delivers Speed & Energy Efficiency to Organic Grocer

NATIVE SUN NATURAL FOODS

Jacksonville, FL

18,300 sq.ft.

Builder:

STT Construction

Jacksonville, FL

Architect:

K-10 Design

Orlando, FL



"It speaks for itself when it's 110 degrees outside, and you don't have to run your air conditioning."

- Aaron Gottlieb, owner
Native Sun Natural Foods

SPEED

When organic grocery store owner, Aaron Gottlieb, chose to use Koreteck on his new 18,300 square foot store, he knew the system would save him time and installation costs.

In fact, the Koreteck system installed so easily and quickly, Aaron saved considerable labor costs—especially compared with concrete block construction he originally considered.

“We were looking for ways to economize on construction,” he confided. “I understand labor costs as well as material costs, and when I looked at the Koreteck system, I could see how using it would eliminate extra trades.”

“It took about 10 days, not including downtime, to put up our walls, and it would have taken less without weather and other constraints,” he recalls. “Everything went together like a jigsaw puzzle.”



The all-in-one nature of the Koreteck system makes it no longer necessary to coordinate multiple crews and subsequent inspection schedules. The simplicity of the Koreteck system enables these functions to be completed in a fraction of the time of traditional building methods.

The “Speed” Benefits of Koreteck

- One-piece wall system installs faster
- Lightweight, easy to handle
- No heavy equipment necessary
- Requires fewer trades
- “Weathered in” faster
- Less jobsite waste

Installation Time Comparison*

Trades		Week 1	Week 2	Week 3	Week 4
Traditional	Stud	-----			
	Sheathing		-----		
	Insulation (Blanket)		-----		
	EIFS Prep		-----		
Block	Block	-----			
	EIFS Prep		-----		
Koreteck	Koreteck System	-----			
	Coating Prep		-----		

*Timelines indicated are based on average construction schedules. Koreteck timeline assumes familiarity and experience installing the system.

What Aaron didn't realize when he chose Koreteck was the amazing energy savings the system would provide. Although 45 tons of air conditioning equipment was installed to cool the building, it has proven to be over-designed. The 24.8 R-value of Koreteck's 6-inch panel system combined with the refrigerated food cases used in Aaron's Native Sun grocery kept the 18,300 square foot space cooled; even during August in Florida.

"The building was like a big walk-in cooler. In the middle of August in Jacksonville, Florida, we actually had to turn on the heat for two days until we got everything balanced. The building was maintaining a temperature of about 62 degrees Fahrenheit when closed, and about 68 degrees when open."



LEFT: Once erected, the panels took a minimal amount of infill to achieve the waved shapes. An acrylic stucco finish was then applied directly to the Koreteck panel surface.

Not only is Koreteck ideal for the grocery industry, this innovative panelize system has proven the perfect solution for medical facilities, industrial complexes, and churches all over the country.

The solid composition of the Koreteck system also enhances acoustical performance and virtually eliminates the water and food sources necessary for mold to grow.

The Perform Guard® EPS material used by Koreteck is a natural deterrent to termites, has been thoroughly tested, and is safe, noncorrosive, and nontoxic. The Koreteck system has been independently tested for structural, fire, vapor, and sound transmission characteristics. The technology is ICC approved and is now approved by Miami-Dade County, FL for use in high-velocity hurricane zones of the Florida Building Code.

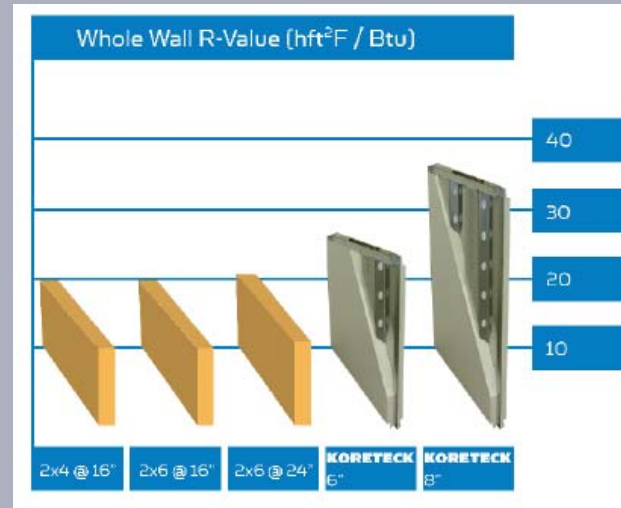

The ever-increasing costs of electricity and heating oil have placed even greater emphasis on the need for energy-efficient building solutions. The Koreteck panelized building system creates high R-values more efficiently than traditional construction methods, offering the building owner significant energy savings over the life of the building.

The Energy Benefits of Koreteck

- Monolithic EPS insulation provides high energy efficiency
- No thermal bridging at panel-to-panel connection
- 6-inch system delivers R-value of 24.8 at 40°F
- 8-inch system delivers R-value of 33.1 at 40°F



KORETECK™
PANELIZED BUILDING SYSTEM

THE KORETECK® SYSTEM

Not just a better wall. A better way.

The Koreteck panelized building system is a complete envelope system that replaces metal studs, insulation, and exterior sheathing with the superior performance of a solid noncavity wall. Installation is fast and easy with no need for highly skilled labor. Interior and exterior finishes can be applied just as with any other building material.

Koreteck system panels are made with a solid galvanized 20-gauge steel core surrounded by Perform Guard® EPS insulation.

A series of panels are connected together with system fasteners to create the core of the building envelope.

Once complete, the Koreteck system creates proven performance attributes.

TESTED AND CERTIFIED

Koreteck wall panels have been independently tested for structural, fire, vapor transmission, and sound transmission characteristics.

ASTM D-3273 - standard test method for resistance to mold growth
 UBC 26-9/NFPA-285 - flammability characteristics for non loadbearing wall assemblies
 UL 263/ASTM E-119/NFPA-251 - one- and two-hour fire rated assemblies
 ASTM E-96 - standard test method for water vapor transmission
 ASTM E-90 - standard test method for airborne sound transmission loss (STC)
 Meets requirements of ICC (International Code Council) (PFC-5881)

NEW! Now approved by Miami-Dade County, FL for use in high-velocity hurricane zones of the Florida Building Code



MOLD RESISTANCE

NOISE REDUCTION

Koreteck vs. cavity wall construction

	Koreteck	cavity wall
Elimination of Food Sources		
Eliminates Sheathing	YES	NO
Eliminates Paper Backing on Blanket	YES	NO
Eliminates Studs (Wood)	YES	NO
Eliminates Presence of Water	YES	NO
Noncavity Advantages		
Eliminates Space	YES	NO
Eliminates Airflow	YES	NO

STC Ratings of Koreteck System

Description	Estimated STC Rating	Wall Assembly
Koreteck wall system with 1/2" gypsum board and 5/8" gypsum board	37	
Koreteck wall system with 1/2" gypsum board	33	

CERTIFIED INSTALLERS

The Koreteck panelized building system may only be installed by Koreteck certified installers. The Installation Training and Certification Course is available nationwide. In it, Koreteck offers builders a comprehensive training experience. This day-long course combines both classroom and hands-on exercises, providing participants with a better understanding of the Koreteck system as well as its proper installation.

SUSTAINABILITY

Koreteck beats traditional construction methods on key aspects of sustainability

	Koreteck	Wood studs, fiberglass insulation, and sheathing
Protects against deforestation	YES	NO
Uses fewer natural resources	YES	NO
Better heating and cooling efficiency	YES	NO